

PARK BENCH SERIES E

SPECIFICATIONS

WOOD:

- SEAT: 38.1 x 139.7 x 1778.0mm (1 1/2"x 5 1/2"x70")
- BACK: 38.1 x 88.9 x 1778.0mm (1 1/2"x 3 1/2" x 70")

WOOD OPTIONS:

1. CEDAR- LIFETIME PRESERVATIVE OR SIKKENS STAIN.
2. PINE- ACQ PRESERVATIVE.

STEEL TYPE:

- 50.8 x 50.8mm (2"x 2") SQUARE TUBE FRAME AND LEGS

FASTENERS:

- 9.5mm (3/8") PLATED CARRIAGE BOLTS. COLOR MATCHED TO STEEL FRAME.

STEEL FINISH:

- 3 STEP POWDER COAT PROCESS:

 1. SURFACE PREPARATION- SANDBLAST METAL
 2. PRIME COAT- APPLICATION OF ZINC RICH PRIMER
 3. TOP COAT- FINAL COATING IS BAKED ON FOR THE BEST IN LONG LASTING DURABILITY

STEEL FRAME AVAILABLE IN A WIDE VARIETY OF COLORS. REFER TO COLOR CHART FOR MORE INFORMATION.

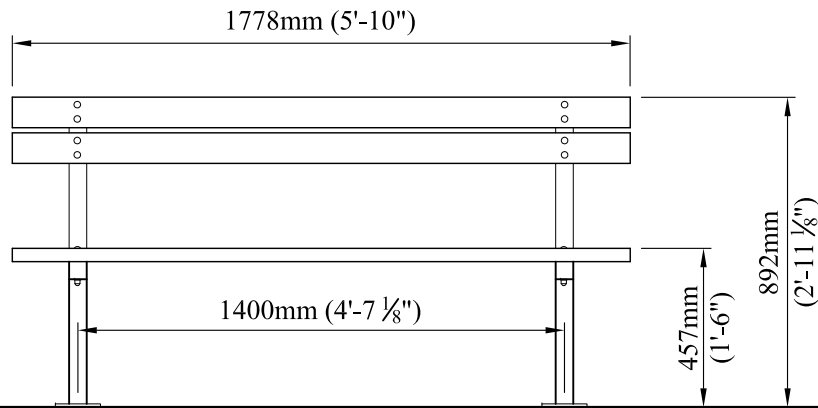

FRONT VIEW

SURFACE MOUNT (BES)

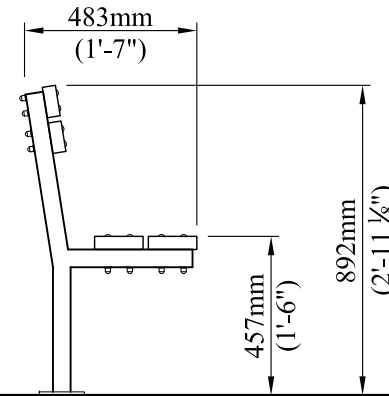

END VIEW

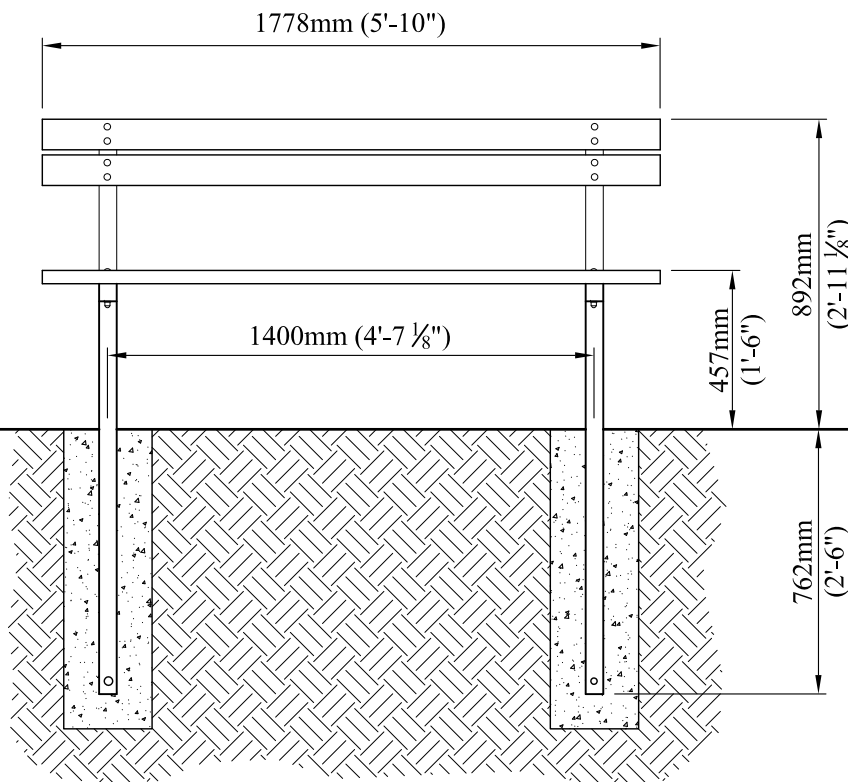

FRONT VIEW

IN GROUND (BEG)

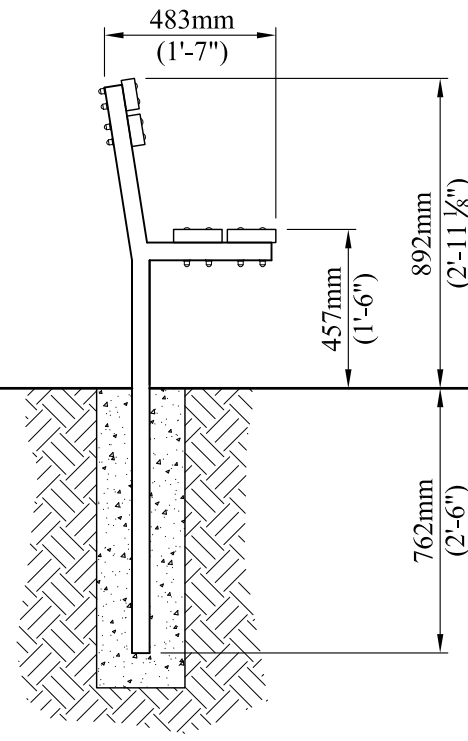

END VIEW



4111-17th Street SE Calgary, AB T2G 3W5
 Ph# 569-8180 Fax# 272-4544
 e-mail: reception.cpl@telus.net
www.custompark.com